



BEVERAGE-AIR

3779 Champion Blvd., Winston-Salem, NC 27105
1-888-845-9800 Fax# 1-336-245-6453
<http://www.Beverage-Air.com>

CUSTOMER'S CHOICE FOR A *HOT* LOCATION
Tested & Certified to Ambient Class of 100°F

3 Year Parts/Labor Warranty Additional 2 Year Compressor Warranty

DIRECT DRAW DISPENSERS

Direct Draw Beer Dispensers are available in 6 self-contained models up to 5 kegs capacity. Three models are available as club top (DD50C, DD58C, DD68C) for glasses, cans or bottles storage beneath an easy glide stainless steel lid. Two remote models (DD58R and DD78R) complete the series of direct draws.

CABINET CONSTRUCTION

Standard, cabinet exterior construction includes attractive, wear resistant vinyl on steel in black exterior finish. Top is made from heavy-duty stainless steel including drip tray(s) for easy cleaning.

Doors are self-closing and include key locks. Magnetic gaskets provide positive door sealing.

Standard interior construction utilizes galvanized steel walls and ceiling. Reinforced floor and door sills are made from heavy-duty stainless steel to provide long lasting service.

Foamed-in-place CFC and HCFC-free polyurethane insulation enhances the structural strength of the cabinet and helps increase energy efficiency.

Three-inch (3") insulated towers are provided. Towers are adapted to have a continuous source of cold air channeled into it to keep beer at its coldest, best quality the moment it is dispensed.

Drain tube located at bottom front of cooler for connection to floor drain.

REFRIGERATION

Models feature forced air refrigeration to keep beer in kegs ice cold for dispensing. Refrigeration system uses R134a refrigerant, which is CFC and HCFC-free for compliance with environmental safety concerns.

ELECTRICAL

Units wired at factory and ready for connection to a 115/60/1 phase, 15 amp dedicated outlet. 8' long cord and plug set included.

SPECIAL FEATURES

- Stainless options available
- 3 Club Top models available
- Drain tube located at bottom front of cooler for connection to floor drain.

DRAFT BEER EQUIPMENT DIRECT DRAW DISPENSERS DD SERIES

MODELS:

DD24
DD50/DD50C
DD58/DD58C/DD58R
DD68/DD68C
DD78/DD78R
DD94



DD50



DD68C



DD94



*Note: Not all markings may apply to all model variations.



BEVERAGE-AIR

Direct Draw Dispensers

Models: DD24, DD50, DD50C, DD58, DD58C, DD58R, DD68, DD68C, DD78, DD78R, DD94

ELECTRICAL CONNECTION

Units pre-wired at factory and include 8' long cord and plug set.



115/60/1
NEMA-5-15P

PLAN VIEWS



FRONT
DD24

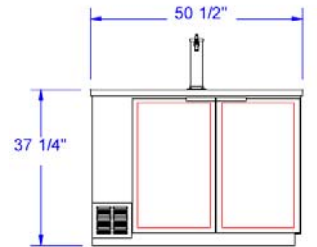

FRONT VIEW
DD50

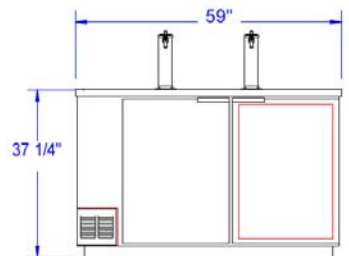

FRONT VIEW
DD58

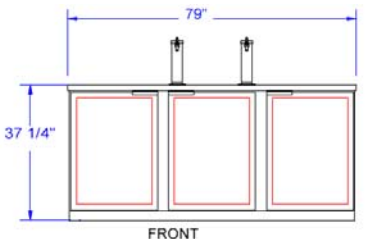

DD78

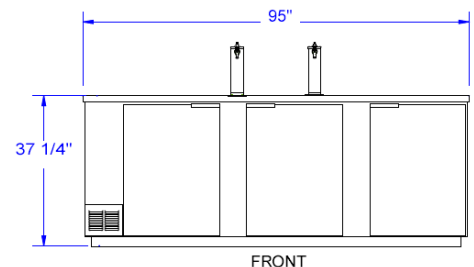

FRONT

| MODEL | DD24 | DD50 | DD50C | DD58 | DD58C | DD58R | DD68 | DD68C | DD78 | DD78R | DD94 |
|----------------------------------|---------|----------|----------|----------|----------|----------|----------|----------|----------|----------|----------|
| EXTERNAL DIMENSIONAL | | | | | | | | | | | |
| Length Overall (inches) | 24" | 50 1/2" | 50 1/2" | 59" | 59" | 59" | 69" | 69" | 79" | 79" | 95" |
| Length Overall (mm) | 610 | 1283 | 1283 | 1499 | 1499 | 1499 | 1753 | 1753 | 2007 | 2007 | 2413 |
| Depth Overall (inches) | 29 1/2" | 28 3/16" | 28 3/16" | 28 3/16" | 28 3/16" | 28 3/16" | 28 3/16" | 28 3/16" | 28 3/16" | 28 3/16" | 28 3/16" |
| Depth Overall (mm) | 749 | 716 | 716 | 716 | 716 | 716 | 716 | 716 | 716 | 716 | 716 |
| Height Overall— (inches) | 37 3/4" | 37 1/4" | 38 3/4" | 37 1/4" | 38 3/4" | 37 1/4" | 37 1/4" | 38 3/4" | 37 1/4" | 37 1/4" | 37 1/4" |
| Height Overall—(mm) | 959 | 946 | 984 | 946 | 984 | 946 | 946 | 984 | 946 | 946 | 946 |
| Depth with door open (inches) | 46 3/4" | 46 3/4" | 46 3/4" | 50 9/16" | 50 9/16" | 50 9/16" | 50 9/16" | 50 9/16" | 50 9/16" | 50 9/16" | 50 9/16" |
| Number of doors | 1 | 2 | 2 | 2 | 2 | 2 | 2 | 2 | 3 | 3 | 3 |
| INTERNAL DIMENSIONAL | | | | | | | | | | | |
| NET Capacity (cubic ft.) | 7.8 | 19.8 | 19.8 | 23.8 | 23.8 | 23.8 | 28.4 | 28.4 | 34.2 | 34.2 | 39.7 |
| NET Capacity (Liters) | 221 | 561 | 561 | 674 | 674 | 674 | 804 | 804 | 968 | 968 | 1110 |
| Internal Length Overall (inches) | 19" | 46 1/2" | 46 1/2" | 55" | 55" | 55" | 65" | 65" | 75" | 75" | 91" |
| Internal Length Overall (mm) | 483 | 1181 | 1181 | 1397 | 1397 | 1397 | 1651 | 1651 | 1905 | 1905 | 2316 |
| Internal Depth Overall (inches) | 23 3/4" | 23" | 23" | 23" | 23" | 23" | 23" | 23" | 23" | 23" | 23" |
| Internal Depth Overall (mm) | 603 | 584 | 584 | 584 | 584 | 584 | 584 | 584 | 584 | 584 | 584 |
| Internal Height Overall (inches) | 29 1/2" | 32" | 32" | 32" | 32" | 32" | 32" | 32" | 32" | 32" | 32" |
| Internal Height Overall (mm) | 749 | 813 | 813 | 813 | 813 | 813 | 813 | 813 | 813 | 813 | 813 |
| Number of Kegs (1/2 barrel) | 1 | 2 | 2 | 3 | 3 | 3 | 3 | 3 | 4 | 5 | 5 |
| ELECTRICAL DATA | | | | | | | | | | | |
| Full Load Amperes 115/60/1 | 4.0 | 7.4 | 7.4 | 7.4 | 7.4 | .5 | 7.4 | 7.4 | 7.4 | .5 | 7.4 |
| ENERGY CONSUMPTION | | | | | | | | | | | |
| | N/A | 3.69 | 3.69 | 4.37 | 4.37 | n/a* | 3.55 | 3.55 | 4.02 | n/a* | 4.8 |
| REFRIGERATION DATA | | | | | | | | | | | |
| Horsepower | 1/5 | 1/3 | 1/3 | 1/3 | 1/3 | remote | 1/3 | 1/3 | 1/3 | remote | 1/3 |
| WEIGHT DATA | | | | | | | | | | | |
| Gross Weight (Crated lbs) | 180 | 294 | 310 | 348 | 353 | 298 | 370 | 380 | 424 | 386 | 478 |
| Gross Weight (Crated kg) | 82 | 133 | 140 | 157 | 160 | 135 | 168 | 172 | 192 | 175 | 216 |



*Note: Not all markings may apply to all model variations.

*N/A: Not available at time of printing.

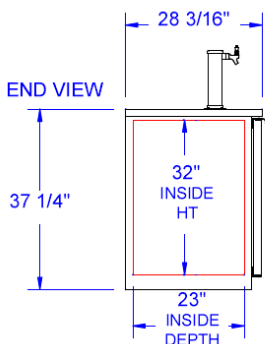

COMMON END VIEW

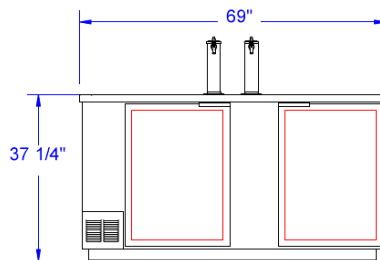

FRONT
DD68

DD94

BEVERAGE-AIR® CORPORATION

3779 Champion Blvd. • Winston-Salem, NC 27105 USA • (336) 245-6400 • Fax (336) 245-6453 • (888) 845-9800 • www.beverage-air.com

Specifications are subject to change without prior notice. 07/16